

ResinDek® Panels Over Bar Grate Installation Instructions

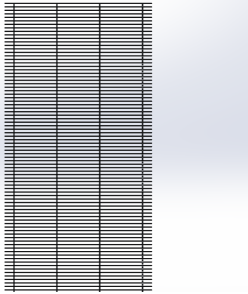

1. Inspect Bar Grate

Be sure that bar grate is undamaged and capable of supporting anticipated traffic.

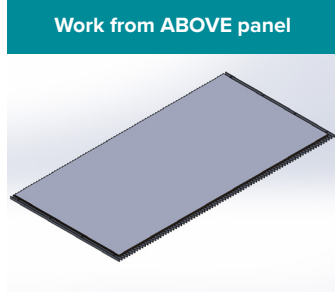

2. Layout Panels

Layout and properly space ResinDek panels over bar grate (see ResinDek Installation Instructions).



3. Two People Per Panel

A minimum of 2 people are needed to install each panel.

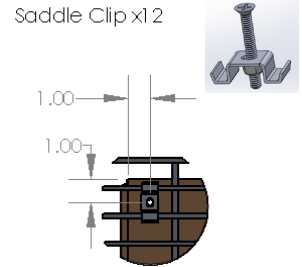

4. Saddle Clips

You will be installing 12 saddle clip assemblies per panel (4 rows of 3), see sample layout below. Follow steps 5-9 for installation.

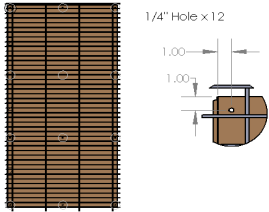

5. Pre-drill Panel

Pre-drill 1/4" holes from underneath, centered between the bar grate vertical bars.

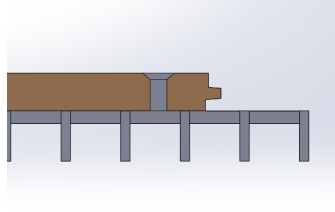

6. Countersink Holes

Countersink all predrilled holes with a 1/2" approximate countersink bit.

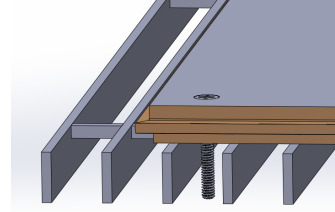

7. Insert bolts

Drop in bolts.

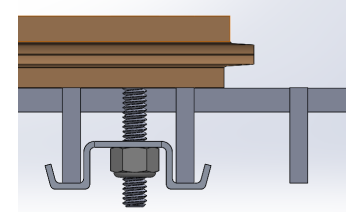

8. Install Saddle Clips

Install saddle clips and tighten locknuts.

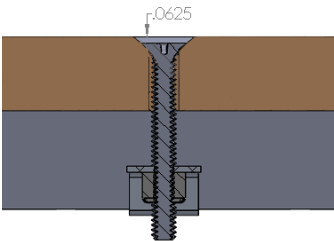

9. Check Screws & Clips

When assembled properly, the head of the screw will rest just below the panel surface, and the saddle clip will cover 2 adjacent bars.

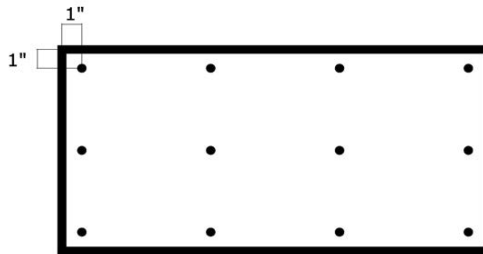

Sample Layout (top of panel)

Hole locations are approximate, be sure to place holes no closer than 1" to any edge. Position holes to miss bar grate and to accommodate saddle clip flanges.

Note: This pattern is for 4' x 8' panels. Fastener patterns for other panel sizes should use 1 saddle clip assembly per 2.66 SF area.

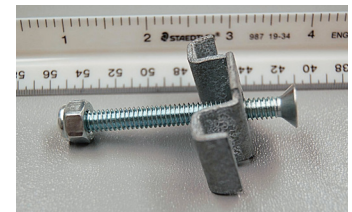

Assembled Screw & Clip

Above shows an assembled screw and clip.